



CATALOGUE

2023

QUALITY VALVE

The ZencQ is part of NEORUBY GmbH.

NEORUBY is an international team with over 20 years of experience in various European markets, experts in finding the right sales channels and creating new market opportunities with new brands.

ZencQ has collected advantages, solutions, features of various products and markets based on the experience of NEORUBY.

A new look at reliable things allows you to keep up with the technological time of today.

You will say «Thank you» for brand ZencQ.

Brand zencQ belongs to NEORUBY GmbH

NEORUBY GmbH • Am Hamburger Bahnhof 3,
10557 Berlin, Germany

www.zencq.com



ZencQ manufacturing facilities are located in China.

Quality and brand is the foundation of the enterprise.

The company always adheres to the high level of quality as the guiding principle, the implementation of strict management and product quality control, each link in production in accordance with the ISO9001: 2008 international quality management system.

HERE IS HOW **ZENCQ** PRODUCTS ARE DEVELOPED

01



100+ MODELS AND
DRAWINGS



02



STRICTLY SELECTED
MATERIAL



03



PRECISELY CONTROLLED
PROCESS



04



ENGINEERING BY
TECHNICIANS WITH 20+
YEARS OF EXPERIENCE

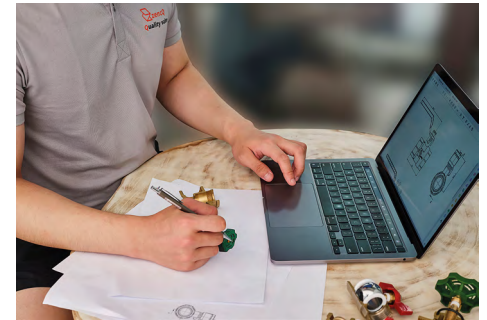

05



QUALITY ASSURANCE
AFTER 10+ TESTING
STEPS



06



ACHIEVE ZENCQ
PRODUCTS



CERTIFICATE OF CONFORMITY

Ref. Certif. No.: KB2012311P01

This Certificate is issued to
 Applicant : YUHUAN ZHENGQU FLUID INTELLIGENCE CONTROL CO., LTD.
 SHAMEN INDUSTRIAL AREA, YUHUAN, ZHEJIANG, CHINA

Manufacturer : Same as applicant

FOR

Product : CHECK VALVE

Trademark : / /

Model / Type : 1/2", 3/4", 1", 1-1/4", 1-1/2", 2", 2-1/2", 3", 4"

Specification : EN 12266-1:2012

Directive : 2014/68/EU on Pressure Equipment, Module A

Test Report : PE20123116

Date of Test Report : 17 December 2020

Summary:
 A sample of product submitted was tested and was found to comply with the test requirements for metallic valves of the above standard.
 This certificate is part of the full report and should be read in conjunction with it. This certificate remains the property of KTS and shall be returned upon request. The use of this certificate is subjected to the terms and conditions of the test certification scheme.

Authorized by:

JACK SENG MANAGER
 Date: 16 December 2020

After preparation of the necessary technical documentation as well as the declaration of conformity the required CE marking can be affixed on the product. Other relevant directives have to be observed.

SHENZHEN KTS TESTING SERVICES LTD
 4/F, Fuding Bldg, Xixiang Road Crossing, Zone E2, Xixiang Town, Baoan District, Shenzhen, China
 Tel: +86-755-26496952 Fax: +86-755-26496948 www.sz-kts.com.cn KTS@KTS.com.cn

Ref. Certif. No.: KB2012311T01

This Certificate is issued to
 Applicant : YUHUAN ZHENGQU FLUID INTELLIGENCE CONTROL CO., LTD.
 SHAMEN INDUSTRIAL AREA, YUHUAN, ZHEJIANG, CHINA

Manufacturer : Same as applicant

FOR

Product : BIBCOCK

Trademark : / /

Model / Type : 1/2"x1/2", 1/2"x3/4", 3/4"x3/4", 3/4"x1", 1"x1"

Specification : EN 200:2008

Test Report : WT20123117

Date of Test Report : 17 December 2020

Summary:
 A sample of product submitted was tested and was found to comply with the test requirements for taps of the above standard.
 This certificate is part of the full report and should be read in conjunction with it. This certificate remains the property of KTS and shall be returned upon request. The use of this certificate is subjected to the terms and conditions of the test certification scheme.

Authorized by:

JACK SENG MANAGER
 Date: 16 December 2020

After preparation of the necessary technical documentation as well as the declaration of conformity the required CE marking can be affixed on the product. Other relevant directives have to be observed.

SHENZHEN KTS TESTING SERVICES LTD
 4/F, Fuding Bldg, Xixiang Road Crossing, Zone E2, Xixiang Town, Baoan District, Shenzhen, China
 Tel: +86-755-26496952 Fax: +86-755-26496948 www.sz-kts.com.cn KTS@KTS.com.cn

CERTIFICATE OF CONFORMITY

Certificate No.: KB18119044PE1

EU Directive 2014/68/EU (PED)

Applicant : YUHUAN ZHENGQU FLUID INTELLIGENCE CONTROL CO., LTD.
 Address : SHAMEN INDUSTRIAL AREA, YUHUAN, ZHEJIANG, CHINA

Manufacturer : Same as applicant
 Address : Same as applicant

Product : STRAINER VALVE

Model(s) No. : 1/4", 3/8", 1/2", 3/4", 1", 1-1/4", 1-1/2", 2", 2-1/2", 3", 4"

The submitted products have been tested by us with the following standard(s) and found to be in compliance with the EU Directive listed:

CONFORMITY DETAILS			
EU Directive	Applicable Standard(s)	Documentary Evidence	Result
2014/68/EU (PED)	EN 12266-1:2012	Test Report PE18119044	Conform

The test results apply only to the particular sample tested and to the specific tests carried out. Technical Report and documentation are at the applicant disposal.

Authorized by:

JACK SENG MANAGER
 Date: November 13, 2018

This certificate applies specifically to the sample investigated. In our test reference number only, the CE marking as shown above can be affixed, under the responsibility of the manufacturer.

SHENZHEN KTS TESTING SERVICES LTD
 4/F, Fuding Bldg, Xixiang Road Crossing, Zone E2, Xixiang Town, Baoan District, Shenzhen, China
 TEL: 0086-755-26496952 FAX: 0086-755-26496948 WWW.SZ-KTS.COM.CN KTS@SZ-KTS.COM.CN

CERTIFICATE OF COMPLIANCE

Certificate No.: HK-ZQ-190808.PED

Applicant: YUHUAN ZHENGQU FLUID INTELLIGENCE CONTROL CO., LTD.
 Address : SHAMEN INDUSTRIAL AREA, YUHUAN, ZHEJIANG, CHINA

Manufacturer : YUHUAN ZHENGQU FLUID INTELLIGENCE CONTROL CO., LTD.
 Address : SHAMEN INDUSTRIAL AREA, YUHUAN, ZHEJIANG, CHINA

Product : BALL VALVE

Model No. : 1/4", 3/8", 1/2", 3/4", 1", 1-1/4", 1-1/2", 2", 2-1/2", 3", 4"

Trade Mark :

Declaration:
 The submitted products have been tested by us with the following standard(s) and found to be in compliance with the directive listed below.

Directive :	EU Directive 2014/68/EU (PED)
Report number :	Test Report OKAL.BG-190807
Result :	Conform

Remark: The test results apply only to the particular sample tested and to the specific tests carried out. Technical Report and documentation are at the applicant disposal.
 This certificate applies specifically to the sample investigated in our test reference number only.
 The marking as shown above can be affixed, under the responsibility of the manufacturer.
 If all relevant and effective EC Directives are complied with.
 This Certificate of Compliance can be checked for validity at <http://en.okalcert.com>
 This verification doesn't imply assessment of the production of the product(s).

Attestation By

Tim Mahan/Senior Manager

DATE OF ISSUE : 06/08/2019
 DATE OF EXPIRE : 07/08/2024

OKAL INTERNATIONAL TESTING AND CERTIFICATION (HK) LIMITED
 Tel: 00852-30717723 E-mail: OKAL@okalcert.com
<http://www.okalcert.com>

Environmentally Certified

Certificate of Registration

Yuhuan Zhengqu Fluid Intelligence Control Co., Ltd.
 ABN: 9133102106564052TU

Registered address: Bingang Industrial City, Shamen Town, Yuhuan City, Zhejiang Province, China.
 Audit address: Bingang Industrial City, Shamen Town, Yuhuan City, Zhejiang Province, China.

operates an

Environmental Management System

which complies with the requirements of:

ISO 14001:2015

The registration covers the manufacture and sale of valves (excluding qualification licensed products).

Original Certification: 24/10/2018
 Issue/Revised Date: 25/10/2021

Registration No: CN2475-EC
 Expiry Date: 24/10/2021

Craig J Bates
 President
 TQCSI International (Group) Pty Ltd
 For the TQCSI Certification Approval Panel

Lorraine Welsh
 Accreditation Manager
 TQCSI International Pty Ltd

This certificate verifies the original certificate issued and is valid as long as it is displayed as an electronic copy at www.tqcsi.com.au and accordance with the sustainability concerned. TQCSI International Pty Ltd (ABN 91 331 021 065) is a Registered Quality Provider. 111A, Taggerty Hill Road, Herndon, SA 5174, Australia issues certification subject to the TQCSI Rules of Certification. The certificate can be verified on OKAL web site at www.okalcert.com.

TQCSI INTERNATIONAL PTY LTD www.tqcsi.com.au
 www.ascb.com.au www.iaf.org www.jas-anz.com

Quality Certified

Certificate of Registration

Yuhuan Zhengqu Fluid Intelligence Control Co., Ltd.
 ABN: 9133102106564052TU

Registered address: Bingang Industrial City, Shamen Town, Yuhuan City, Zhejiang Province, China.
 Audit address: Bingang Industrial City, Shamen Town, Yuhuan City, Zhejiang Province, China.

operates a

Quality Management System

which complies with the requirements of:

ISO 9001:2015

The registration covers the manufacture and sale of valves (excluding qualification licensed products).

Original Certification: 24/10/2018
 Issue/Revised Date: 25/10/2021

Registration No: CN2475-QC
 Expiry Date: 24/10/2021

Craig J Bates
 President
 TQCSI International (Group) Pty Ltd
 For the TQCSI Certification Approval Panel

Lorraine Welsh
 Accreditation Manager
 TQCSI International Pty Ltd

This certificate verifies the original certificate issued and is valid as long as it is displayed as an electronic copy at www.tqcsi.com.au and accordance with the sustainability concerned. TQCSI International Pty Ltd (ABN 91 331 021 065) is a Registered Quality Provider. 111A, Taggerty Hill Road, Herndon, SA 5174, Australia issues certification subject to the TQCSI Rules of Certification. The certificate can be verified on OKAL web site at www.okalcert.com.

TQCSI INTERNATIONAL PTY LTD www.tqcsi.com.au
 www.ascb.com.au www.iaf.org www.jas-anz.com

证书



CERTIFICATE

玉环正渠流体智控有限公司:
 贵单位产品已由中国人民财产保险股份有限公司承担产品责任险。
 保险期间自2020年11月25日零时起至2021年11月24日二十四时止
 保单号: PZAH202033100000000126

 X 中国人民保险 中国人民财产保险股份有限公司台州分公司
 2020年11月24日

QUALITY IS OUR MISSION

VALUE PROPOSITION

-  Provide quality products and quality products only
-  Gain long-term trust of the customers
-  Try to be the first choice in the industry

WHY ZENCQ?

Since zencQ was established, we have delivered our quality valve products to more than 20 countries. Our products have reached over 50,000 families, and are involved in more than 200 projects around the world. zencQ focuses on quality and is made by designers and engineers with over 20 years of experience.

From sketches over material selection and production, to testing and quality assurance, each step of the process is strictly controlled in accordance with the relevant requirements. All efforts are made to provide quality products to our customers.

1. RADIATOR VALVES 10

- 1.1. Thermostatic radiator valves
- 1.2. H-blocks
- 1.3. Lockshields
- 1.4. Manual radiator valves
- 1.5. Thermostatic head and actuator

2. CONTROL VALVES 16

- 2.1. Automatic air vent
- 2.2. Balancing valves
- 2.3. Pressure reducing valves
- 2.4. Safety group
- 2.5. Y-strainers
- 2.6. Check valves

3. PIPING SYSTEM 21

- 3.1. PE-Xa pipe for underfloor heating

4. MANIFOLD SYSTEM 23

- 4.1. Mixing unit
- 4.2. Actuator
- 4.3. Ball valves for manifolds
- 4.4. Manifolds with flowmeters
- 4.5. Manifolds without flowmeters
- 4.6. Adaptors for multilayer and plastic pipes
- 4.7. Component for manifolds

5. BALL VALVES 31

- 5.1. Ball valves
- 5.2. Ball valves with tail piece
- 5.3. Bibcock
- 5.4. Ball valve with drain and air vent
- 5.5. Drain valve
- 5.6. Ball valve with temperature sensor socket
- 5.7. Ball valve with strainer
- 5.8. Valves for sanitary appliances

1. RADIATOR VALVES



- 1.1. Thermostatic radiator valves
- 1.2. H-blocks
- 1.3. Lockshields
- 1.4. Manual radiator valves
- 1.5. Thermostatic head and actuator



1.1. THERMOSTATIC RADIATOR VALVES

TRV

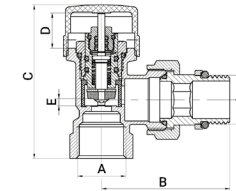

THERMOSTATIC VALVE ANGLE

Nominal diameter – 1/2"
 Nominal working pressure, PN – 10 bar
 Test pressure – 16 bar
 Maximum working temperature – 110°C
 The size of the connection of the thermal head – M30*1,5

A	B, mm	C, mm	D, mm	E, mm	Weight, g	Product code		
1/2"	55	65,5	15	3	221	ZQTRV311D15	1	60

TRV

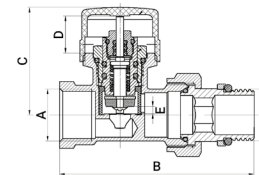

THERMOSTATIC VALVE STRAIGHT

Nominal diameter – 1/2"
 Nominal working pressure, PN – 10 bar
 Test pressure – 16 bar
 Maximum working temperature – 110 °C
 The size of the connection of the thermal head – M30*1,5

A	B, mm	C, mm	D, mm	E, mm	Weight, g	Product code		
1/2"	78,5	43,5	15	3	221	ZQTRV312D15	1	60

TRV

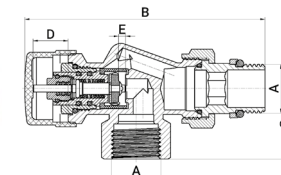

THERMOSTATIC VALVE AXIAL

Nominal diameter – 1/2"
 Nominal working pressure, PN – 10 bar
 Test pressure – 16 bar
 Maximum working temperature – 110°C
 The size of the connection of the thermal head – M30*1,5

A	B, mm	C, mm	D, mm	E, mm	Weight, g	Product code		
1/2"	103	30,5	15	3	280	ZQTRV413D15	1	60

HRV

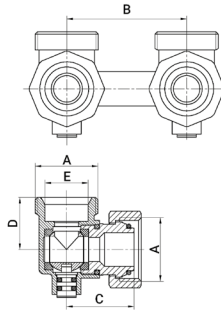

H-VALVE ANGLE

Nominal diameter – 1/2"
 Rated working pressure, PN – 7 bar
 Test pressure – 15 bar
 Maximum operating temperature – 110°C

A	B, mm	C, mm	D, mm	E, mm	Weight, g	Product code		
3/4"	50	27	22	18,1	270	ZQHRV421D20	1	50

HRV

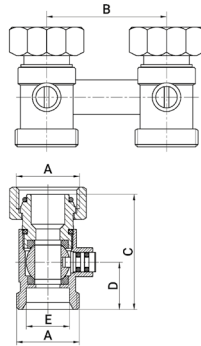

H-VALVE STRAIGHT

Nominal diameter – 1/2"
 Rated working pressure, PN – 7 bar
 Test pressure – 15 bar
 Maximum operating temperature – 110°C

A	B, mm	C, mm	D, mm	E, mm	Weight, g	Product code		
3/4"	50	48	21,2	18,1	260	ZQHRV422D20	1	50

HRV

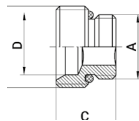

H-VALVE FITTING

Nominal diameter – 1/2"
 Rated working pressure, PN – 7 bar
 Test pressure – 15 bar
 Maximum operating temperature – 110°C

A	B	C, mm	D, mm	Weight, g	Product code		
1/2"	3/4"	19,5	18,1	36	ZQHRV001	1	500

LOC

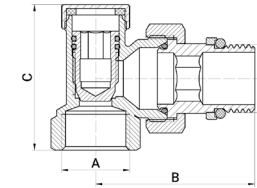

LOCKSHIELD ANGLE

Nominal diameter – 1/2"
 Nominal operating pressure, PN – 10 bar
 Test pressure – 16 bar
 Maximum operating temperature – 110°C

A	B, mm	C, mm	Weight, g	Product code		
1/2"	49	44,5	165	ZQLOC111D15	1	60

LOC

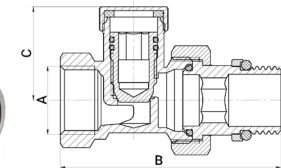

LOCKSHIELD STRAIGHT

Nominal diameter – 1/2"
 Nominal operating pressure, PN – 10 bar
 Test pressure – 16 bar
 Maximum operating temperature – 110°C

A	B, mm	C, mm	Weight, g	Product code		
1/2"	67,5	28,5	153	ZQLOC112D15	1	60

MRV

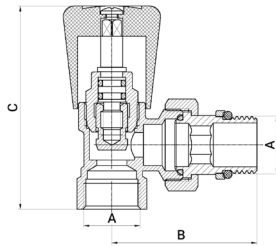

MANUAL RADIATOR VALVE ANGLE

Nominal diameter – 1/2"
 Nominal operating pressure, PN – 10 bar
 Test pressure – 16 bar
 Maximum operating temperature – 110°C

A	B, mm	C, mm	Weight, g	Product code		
1/2"	53	74	215	ZQMRV212D15	1	60

MRV

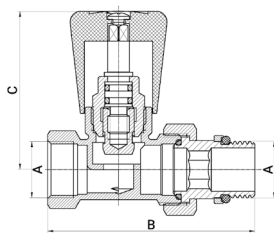

MANUAL RADIATOR VALVE STRAIGHT

Nominal diameter – 1/2"
 Nominal operating pressure, PN – 10 bar
 Test pressure – 16 bar
 Maximum operating temperature – 110°C

A	B, mm	C, mm	Weight, g	Product code		
1/2"	76	57,5	228	ZQMRV211D15	1	60

THE

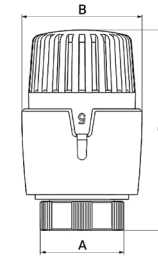

THERMOSTATIC RADIATOR HEAD

Type of connection – Threaded
 Thread size – M30*1,5
 Closing force – 90 N
 Operating temperature range – 6~28°C
 Lower limit of air temperature control (*) – 6°C
 Upper limit of air temperature control – 28°C
 Hysteresis – 1°C
 Influence of differential pressure – 0,3°C
 Influence of coolant temperature – 0,9°C
 Ambient temperature range – -15 ... +50°C
 Maximum allowable static pressure, D – 1,0 MPa
 Maximum allowable pressure drop, W – 0,1 MPa
 Response time, Z – 28 mnts

A	B, mm	C, mm	Weight, g	Product code		
M30*1,5	47,6	81	123	ZQTHE001	1	100

SER

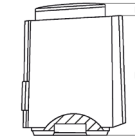
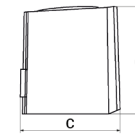
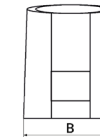

ELECTROTHERMAL ACTUATOR

Connection type – Threaded
 Thread size – M30*1,5
 Developed force on stem – 110 N
 Ambient temperature range (storage) – -5~60°C
 Ambient temperature range (operating) – 0~60°C
 Functional type – NC
 Supply voltage – 220 V
 Frequency – 50 Hz
 Average power – 2-3 W
 Max stroke – 4,5 mm
 Body material – Reinforced nylon
 Protection class against external influences – IP52
 Cycle time (opening / closing) – 3-5 mnts
 Connecting wire cross section – 2 x 0.65 mm²
 Length of cable – 1 m

A	B, mm	C, mm	D, mm	E, mm	F, mm	Weight, g	Product code		
M30*1,5	44,6	48,4	52,2	56	4,5	115	ZQSER1230NC	1	100

2. CONTROL VALVES



- 2.1. Automatic air vent
- 2.2. Balancing valves
- 2.3. Safety group
- 2.4. Pressure reducing valves
- 2.5. Y-strainers
- 2.6. Check valves



2.1. AUTOMATIC AIR VENT



AIR

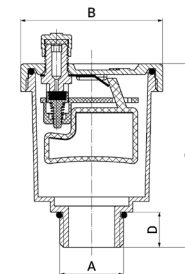

AIR VENT

Maximum working medium temperature – 110°C
 Minimum working medium temperature – -20°C
 Nominal operating pressure, PN – 10 bar
 Test pressure – 15 bar
 Operating pressure range for optimal performance – 0,03 – 0,7 MPa

A	B, mm	C, mm	D, mm	Weight, g	Product code		
1/2"	45,7	72,5	10,5	150	ZQAIR201D15	15	120

AIR

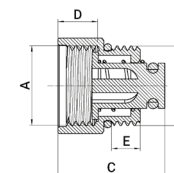

CHECK VALVE FOR AIR VENT

Maximum working medium temperature – 110°C
 Minimum working medium temperature – -20°C
 Nominal operating pressure, PN – 10 bar

A	B	C, mm	D, mm	E, mm	Weight, g	Product code		
1/2"	1/2"	27,9	9,5	6,5	35	ZQAIR202D15	40	400

BAL

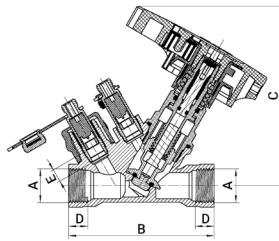

BALANCING VALVE

Maximum working medium temperature – 120°C
 Minimum working medium temperature – -20°C
 Nominal operating pressure, PN – 20 bar
 Test pressure – 25 bar
 Connection type – Threaded
 Threaded connection standard – ISO288/1
 Working environment type – Water, glycol

A	B, mm	C, mm	D, mm	E, mm	Weight, g	Product code		
1/2"	90	111	12	8	570	ZQBAL200D15	1	20
3/4"	97	109,5	14	8	645	ZQBAL200D20	1	20
1"	110	116,5	21,5	8	840	ZQBAL200D25	1	20

SE

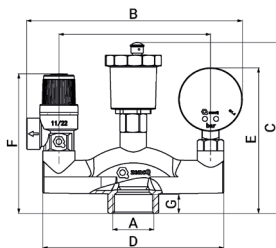

SAFETY GROUP

Maximum working medium temperature – 100°C
 Rated working pressure, PN – 10 bar
 Maximum power of the heating system (boiler) – 50 kW
 Pressure gauge scale limit – 0 ÷ 6 bar
 Relief valve set pressure – 3 bar
 Safety valve connection thread – 1/2"
 Mounting position – Vertical

A	B, mm	C, mm	D, mm	E, mm	F, mm	G, mm	Weight, g	Product code		
1/2"	173	137,3	145	116,9	112,2	15	667	ZQSE01	2	20

SE

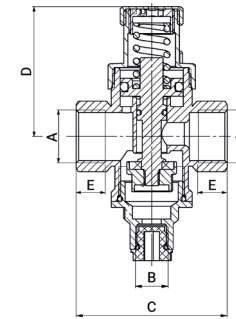

PRESSURE REDUCING VALVE PN16

Maximum working medium temperature – 110°C
 Minimum working medium temperature – 0°C
 Nominal operating pressure, PN – 16 bar
 Pressure setting range – 1-5 bar
 Factory pressure setting – 3 bar
 Working environment type – Water, glycol
 Nominal flow (at 2 m/s according to DIN EN 1567) – 1,305 m³/h

A	B	C, mm	D, mm	E, mm	Weight, g	Product code		
1/2"	1/4"	59,8	51,4	11,5	362	ZQSE201D15	6	60

PRE

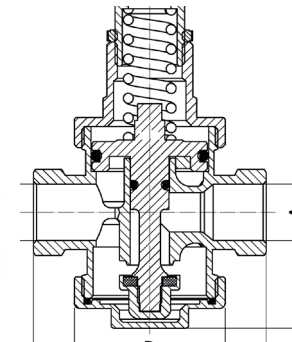

PRESSURE REDUCING VALVE PN25

Maximum working medium temperature – 80°C
 Minimum working medium temperature – 0°C
 Nominal operating pressure, PN – 25 bar
 Pressure setting range – 1-6 bar
 Factory pressure setting – 3 bar
 Working environment type – Water, glycol
 Nominal flow (at 2 m/s according to DIN EN 1567) – 1,305 m³/h
 Flow rate at 3 bar pressure drop (ZQPRE300D25) – 7,68 m³/h
 Flow rate at 3 bar pressure drop (ZQPRE300D32) – 10,2 m³/h

A	B, mm	C, mm	D, mm	Weight, g	Product code		
1"	90	151,5	63,5	1134	ZQPRE300D25	1	12
1 1/4"	77,8	151,5	63,5	1950	ZQPRE300D32	1	8

YS

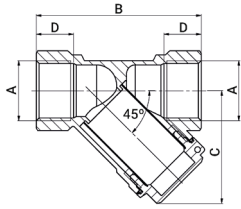

Y-STRAINER

Connection type – Threaded
 Maximum operating temperature – 110°C
 Nominal pressure, PN – 20 bar
 Mesh size (1/2" - 1") – 500 microns
 Mesh size (1*1/4" - 1*1/2") – 700 microns
 Mesh size (2") – 850 microns

A	B, mm	C, mm	D, mm	Weight, g	Product code		
1/2"	57,5	39,3	13	133	ZQYS200D15	16	160
3/4"	65,5	48,7	14,5	207	ZQYS200D20	12	72
1"	75	54,3	15,5	297	ZQYS200D25	8	48
1 1/4"	90	67,2	17,5	540	ZQYS200D32	4	40
1 1/2"	101	78,1	18	718	ZQYS200D40	3	30
2"	122	96	22	1149	ZQYS200D50	2	20

CV

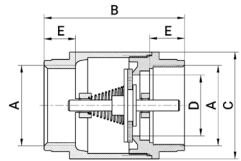

CHECK VALVE

Connection type – Threaded
 Maximum operating temperature – 90°C
 Nominal pressure (1/2" - 1"), PN – 16 bar
 Nominal pressure (1 1/4" - 2"), PN – 10 bar
 Minimum opening pressure – 0,036 bar
 Core material – Brass

A	B, mm	C, mm	D, mm	E, mm	Weight, g	Product code		
1/2"	48	30	15	12,5	125	ZQCV200D15	30	360
3/4"	52	36,6	18,5	13,5	173	ZQCV200D20	15	180
1"	58	44	25	14,5	250	ZQCV200D25	12	144
1 1/4"	66	55,5	28	15	400	ZQCV200D32	6	72
1 1/2"	71	63	38,5	15	550	ZQCV200D40	8	48
2"	80	78	54	16,5	786	ZQCV200D50	3	18

3. PIPING SYSTEM



3.1. PE-Xa pipe for underfloor heating



PEXA



PE-Xa PIPE FOR UNDERFLOOR HEATING

Volume of liquid – 0,113 l/m
 Maximum short-term operating temperature of the medium – 90°C
 Maximum pressure at temperature (95°C) – 10 bar
 Tensile strength at 20°C – 50 bar
 Pressure characteristic – SDR8 / S3,5
 Weight – 90 g/m
 Minimum bend radius – 35 mm
 Wall thermal conductivity – 0,38 W/m °K
 Pipe service life – 50 years

External diameter, mm	Inner diameter, mm	Wall thickness, mm	Product code	Coil length, m
16	12	2	ZQPEXA1620R2	200

4. MANIFOLD SYSTEMS



- 4.1. Mixing unit
- 4.2. Actuator
- 4.3. Ball valves for manifolds
- 4.4. Manifolds with flowmeters
- 4.5. Manifolds without flowmeters
- 4.6. Adaptors for multilayer and plastic pipes
- 4.7. Component for manifolds

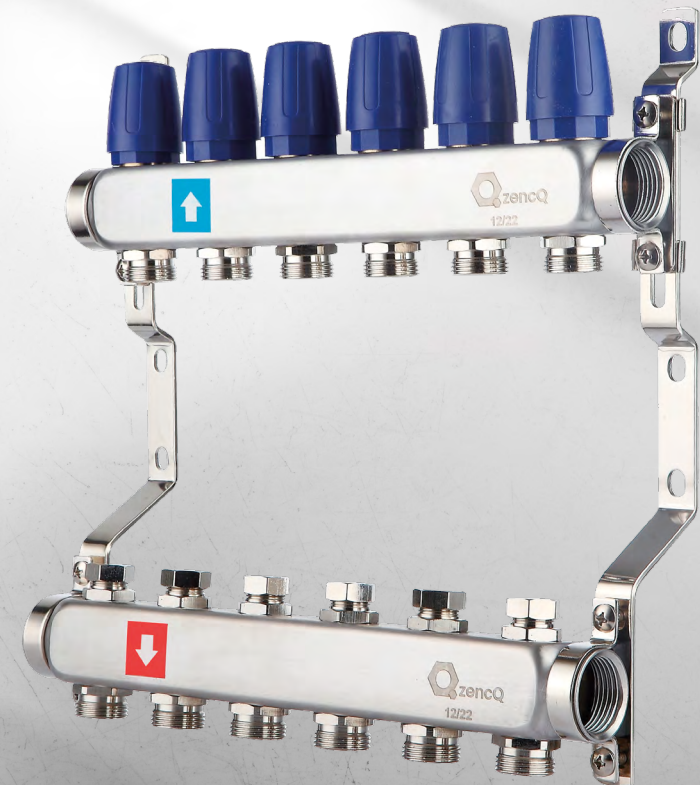

MIX

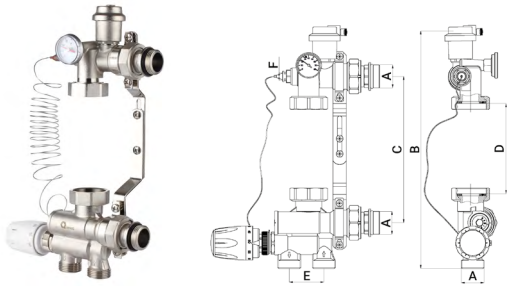

MIXING UNIT WITHOUT PUMP

Maximum primary circuit temperature – 90°C
 Max pressure – 10 bar
 Maximum differential pressure of the primary circuit, ΔP max. – 1 bar
 Minimum differential pressure of the primary circuit, ΔP min. – 0,1 bar
 Temperature control range in the secondary circuit (on the thermal head) – 20÷60°C
 Heating output, (bypass setting 0) – 10 kW
 Heating output, (bypass setting 5) – 12,5 kW
 Max throughput Kv – 4,8 m³/h
 Thermometer scale range – 0 - 80°C
 Connection diameter – 1"
 Pump connection diameter – 1*1/2"
 Installation length of the installed pump – 130 (180) mm
 Thermal head capillary length – 2 m
 Connection thread for thermostatic head – M30*1,5

A	B, mm	C, mm	D, mm	E, mm	F, mm	Weight, g	Product code		
1"	343,5	210-260	130	50	11,5	2255	ZQMIX101D25	1	5

SER

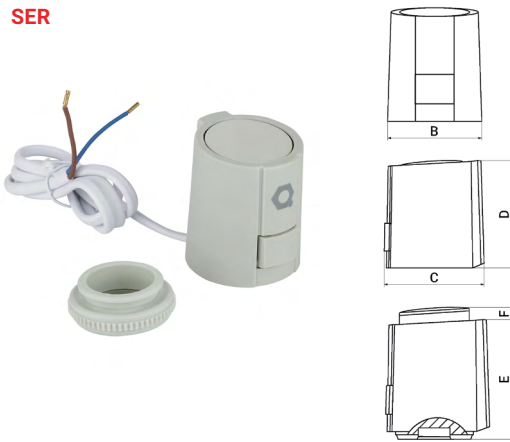

ELECTROTHERMAL ACTUATOR

Connection type – Threaded
 Thread size – M30*1,5
 Developed force on stem – 110 N
 Ambient temperature range (storage) – -5~60 °C
 Ambient temperature range (operating) – 0~60 °C
 Functional type – NC
 Supply voltage – 220 V
 Frequency – 50 Hz
 Average power – 2-3 W
 Max stroke – 4,5 mm
 Body material – Reinforced nylon
 Protection class against external influences – IP52
 Cycle time (opening / closing) – 3-5 mnts
 Connecting wire cross section – 2 x 0.65 mm²
 Length of cable – 1 m

A	B, mm	C, mm	D, mm	E, mm	F, mm	Weight, g	Product code		
M30*1,5	44,6	48,4	52,2	56	4,5	115	ZQSER1230NC	1	100

SPA

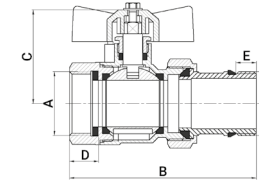

BALL VALVE FOR MANIFOLDS WITH BLUE HANDLE

Closure tightness class – A
 Reparability – Yes
 Nominal diameter – 1"
 Nominal operating pressure, PN – 16 bar
 Maximum operating temperature – 120°C
 Connection type – Threaded
 Threaded connection standard – ISO288/1

A	B, mm	C, mm	D, mm	E, mm	Weight, g	Product code		
1"	96,5	48,3	15	10,5	434	ZQSPA01D25	2	50

SPA

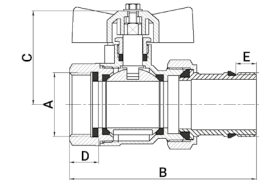

BALL VALVE FOR MANIFOLDS WITH RED HANDLE

Closure tightness class – A
 Reparability – Yes
 Nominal diameter – 1"
 Nominal operating pressure, PN – 16 bar
 Maximum operating temperature – 120°C
 Connection type – Threaded
 Threaded connection standard – ISO288/1

A	B, mm	C, mm	D, mm	E, mm	Weight, g	Product code		
1"	96,5	48,3	15	10,5	434	ZQSPA02D25	2	50

SSM

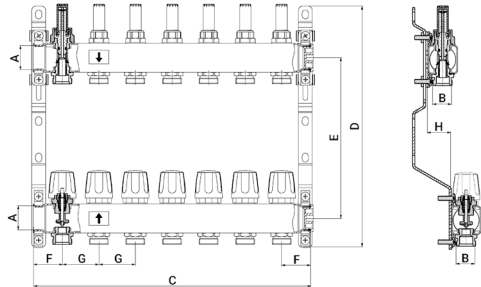
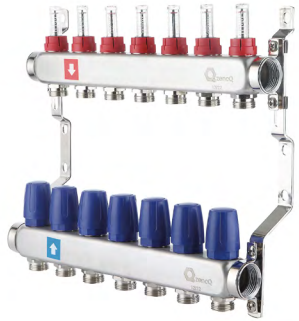

MANIFOLD WITH FLOWMETERS

Maximum working medium temperature – 90°C
 Permissible ambient temperatures – -10 ÷ +40°C
 Working pressure PN – 10 bar
 Outlet thread diameter – 3/4"
 Thermostatic valve thread diameter – M30*1,5
 Center distance (between outputs) – 50 mm
 Thread type – Cylindrical
 Wall thickness – 1,5 mm
 Conditional throughput of the adjusting valve at the indications of the flow meter – 0-5 l/m

A	B	Outputs	C, mm	D, mm	E, mm	F, mm	G, mm	H, mm	Weight, g	Product code		
1"	3/4"	2	130	331	195-220	40	50	32	1417	ZQSSM0125W02	1	5
1"	3/4"	3	180	331	195-220	40	50	32	1836	ZQSSM0125W03	1	5
1"	3/4"	4	230	331	195-220	40	50	32	2262	ZQSSM0125W04	1	5
1"	3/4"	5	280	331	195-220	40	50	32	2673	ZQSSM0125W05	1	5
1"	3/4"	6	330	331	195-220	40	50	32	3101	ZQSSM0125W06	1	5
1"	3/4"	7	380	331	195-220	40	50	32	3522	ZQSSM0125W07	1	5
1"	3/4"	8	430	331	195-220	40	50	32	3952	ZQSSM0125W08	1	5
1"	3/4"	9	480	331	195-220	40	50	32	4359	ZQSSM0125W09	1	3
1"	3/4"	10	530	331	195-220	40	50	32	4790	ZQSSM0125W10	1	3
1"	3/4"	11	580	331	195-220	40	50	32	5198	ZQSSM0125W11	1	3
1"	3/4"	12	630	331	195-220	40	50	32	5643	ZQSSM0125W12	1	3

SSM

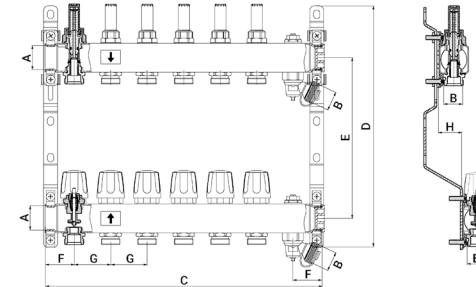
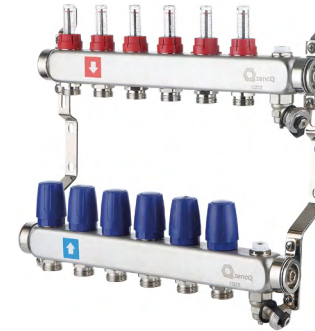

MANIFOLD WITH FLOWMETERS, AIR VENT VALVE AND DRAIN VALVE

Maximum working medium temperature – 90°C
 Permissible ambient temperatures – -10 ÷ +40°C
 Working pressure PN – 10 bar
 Outlet thread diameter – 3/4"
 Thermostatic valve thread diameter – M30*1,5
 Center distance (between outputs) – 50 mm
 Thread type – Cylindrical
 Wall thickness – 1,5 mm
 Conditional throughput of the adjusting valve at the indications of the flow meter – 0-5 l/m

A	B	Outputs	C, mm	D, mm	E, mm	F, mm	G, mm	H, mm	Weight, g	Product code		
1"	3/4"	2	130	331	195-220	40	50	32	1906	ZQSSM0325W02	1	5
1"	3/4"	3	180	331	195-220	40	50	32	2333	ZQSSM0325W03	1	5
1"	3/4"	4	230	331	195-220	40	50	32	2743	ZQSSM0325W04	1	5
1"	3/4"	5	280	331	195-220	40	50	32	3172	ZQSSM0325W05	1	5
1"	3/4"	6	330	331	195-220	40	50	32	3592	ZQSSM0325W06	1	5
1"	3/4"	7	380	331	195-220	40	50	32	4023	ZQSSM0325W07	1	5
1"	3/4"	8	430	331	195-220	40	50	32	4429	ZQSSM0325W08	1	3
1"	3/4"	9	480	331	195-220	40	50	32	4860	ZQSSM0325W09	1	3
1"	3/4"	10	530	331	195-220	40	50	32	5268	ZQSSM0325W10	1	3
1"	3/4"	11	580	331	195-220	40	50	32	5713	ZQSSM0325W11	1	3
1"	3/4"	12	630	331	195-220	40	50	32	6158	ZQSSM0325W12	1	3

SSM



MANIFOLD WITHOUT FLOWMETERS

Maximum working medium temperature – 90°C
 Permissible ambient temperatures – 10 ÷ +40°C
 Working pressure PN – 10 bar
 Outlet thread diameter – 3/4"
 Center distance (between outputs) – 50 mm
 Thread type – Cylindrical
 Wall thickness – 1,5 mm

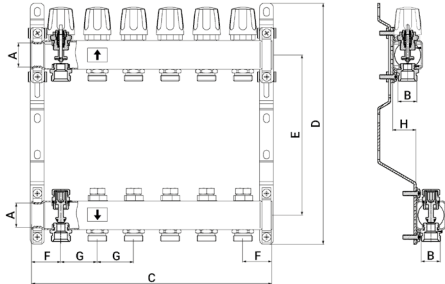

A	B	Outputs	C, mm	D, mm	E, mm	F, mm	G, mm	H, mm	Weight, g	Product code		
1"	3/4"	2	130	331	195-220	40	50	32	1485	ZQSSM0225W03	1	5
1"	3/4"	3	180	331	195-220	40	50	32	1910	ZQSSM0225W03	1	5
1"	3/4"	4	230	331	195-220	40	50	32	2342	ZQSSM0225W04	1	5
1"	3/4"	5	280	331	195-220	40	50	32	2759	ZQSSM0225W05	1	5
1"	3/4"	6	330	331	195-220	40	50	32	3194	ZQSSM0225W06	1	5
1"	3/4"	7	380	331	195-220	40	50	32	3621	ZQSSM0225W07	1	5
1"	3/4"	8	430	331	195-220	40	50	32	4058	ZQSSM0225W08	1	5
1"	3/4"	9	480	331	195-220	40	50	32	4471	ZQSSM0225W09	1	3
1"	3/4"	10	530	331	195-220	40	50	32	4908	ZQSSM0225W10	1	3
1"	3/4"	11	580	331	195-220	40	50	32	5322	ZQSSM0225W11	1	3
1"	3/4"	12	630	331	195-220	40	50	32	5773	ZQSSM0225W12	1	3

SSM

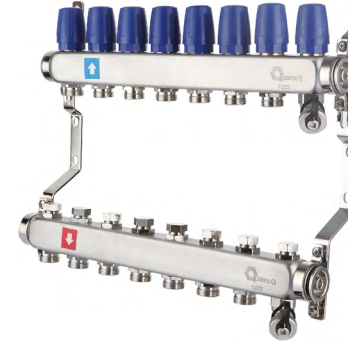

MANIFOLD WITHOUT FLOWMETERS, WITH AIR VENT VALVE AND DRAIN VALVE

Maximum working medium temperature – 90°C
 Permissible ambient temperatures – 10 ÷ +40°C
 Working pressure PN – 10 bar
 Outlet thread diameter – 3/4"
 Center distance (between outputs) – 50 mm
 Thread type – Cylindrical
 Wall thickness – 1,5 mm

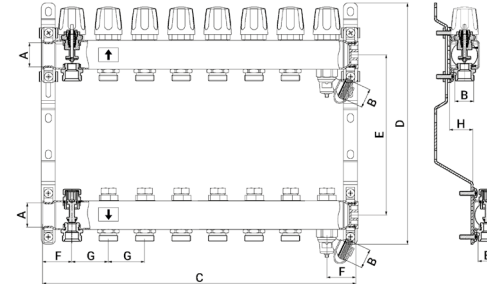

A	B	Outputs	C, mm	D, mm	E, mm	F, mm	G, mm	H, mm	Weight, g	Product code		
1"	3/4"	2	130	331	195-220	40	50	32	1974	ZQSSM0425W03	1	5
1"	3/4"	3	180	331	195-220	40	50	32	2406	ZQSSM0425W03	1	5
1"	3/4"	4	230	331	195-220	40	50	32	2823	ZQSSM0425W04	1	5
1"	3/4"	5	280	331	195-220	40	50	32	3258	ZQSSM0425W05	1	5
1"	3/4"	6	330	331	195-220	40	50	32	3685	ZQSSM0425W06	1	5
1"	3/4"	7	380	331	195-220	40	50	32	4122	ZQSSM0425W07	1	5
1"	3/4"	8	430	331	195-220	40	50	32	4535	ZQSSM0425W08	1	3
1"	3/4"	9	480	331	195-220	40	50	32	4972	ZQSSM0425W09	1	3
1"	3/4"	10	530	331	195-220	40	50	32	5386	ZQSSM0425W10	1	3
1"	3/4"	11	580	331	195-220	40	50	32	5837	ZQSSM0325W11	1	3
1"	3/4"	12	630	331	195-220	40	50	32	6288	ZQSSM0425W12	1	3

EK

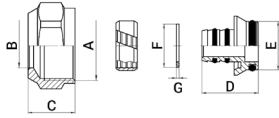

PIPE CONNECTOR BOTH FOR PEX AND PEX-AL-PEX

Maximum operating temperature – 110°C
Nominal pressure, PN – 10 bar
Size – 3/4" * 16 * 2.0 mm

A	B, mm	C, mm	D, mm	E, mm	F, mm	G, mm	Weight, g	Product code		
3/4"	16,5	17,5	21	17,8	16	1	51	ZQEK001	50	200

EK

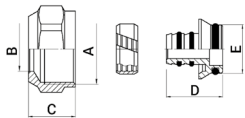

PIPE CONNECTOR FOR PEX

Maximum operating temperature – 110°C
Nominal pressure, PN – 10 bar
Size – 3/4" * 16 * 2.2 mm

A	B, mm	C, mm	D, mm	E, mm	Weight, g	Product code		
3/4"	16,5	17,5	21	17,8	51	ZQEK002	50	200

4.7. COMPONENT FOR MANIFOLDS

SPA

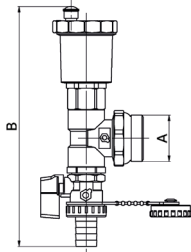

END UNIT WITH DRAIN VALVE AND AUTOMATIC AIR VENT VALVE

Connection type – Threaded
Maximum operating temperature – 110°C
Nominal pressure, PN – 10 bar
Nominal diameter – 1"

A	B, mm	Weight, g	Product code		
1"	107,8	432	ZQSPA10D25	10	40

5. BALL VALVE

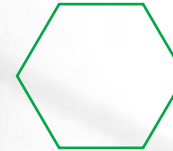

- 5.1. Ball valves
- 5.2. Ball valves with tail piece
- 5.3. Bibcock
- 5.4. Ball valve with drain and air vent
- 5.5. Drain valve
- 5.6. Ball valve with temperature sensor socket
- 5.7. Ball valve with strainer
- 5.8. Valves for sanitary appliances



BV

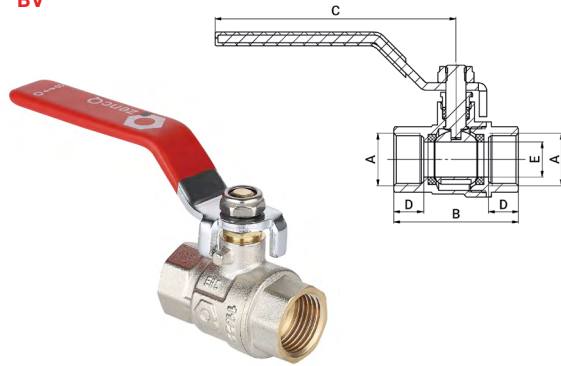

BALL VALVE FEMALE-FEMALE CONNECTION WITH LEVER HANDLE

Closure tightness class – A
 Reparability – Yes
 Nominal diameter – 1/2"
 Nominal operating pressure, PN – 40 bar
 Maximum operating temperature – 100°C
 Minimum operating temperature – -10°C
 Connection type – Threaded
 Threaded connection standard – ISO288/1
 Type of flow section – Full bore
 Body in nickel-plated brass

A	B, mm	C, mm	D, mm	E, mm	Weight, g	Product code		
1/2"	49,8	96,2	12	14	193	ZQBV300D15	10	100
3/4"	55,0	96,2	14	19	261	ZQBV300D20	10	60
1"	64,8	119,2	14,5	23	416	ZQBV300D25	6	36

BV

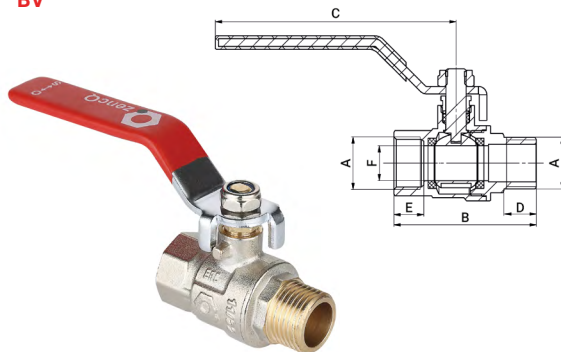

BALL VALVE FEMALE-MALE CONNECTION WITH LEVER HANDLE

Closure tightness class – A
 Reparability – Yes
 Nominal diameter – 1/2"
 Nominal operating pressure, PN – 40 bar
 Maximum operating temperature – 100°C
 Minimum operating temperature – -10°C
 Connection type – Threaded
 Threaded connection standard – ISO288/1
 Type of flow section – Full bore
 Body in nickel-plated brass

A	B, mm	C, mm	D, mm	E, mm	F, mm	Weight, g	Product code		
1/2"	57	96,2	13	12	14	199	ZQBV301D15	10	100
3/4"	64	96,2	14	12,3	19	272	ZQBV301D20	10	60
1"	74	119,2	16	14,5	23	431	ZQBV301D25	6	36

BV

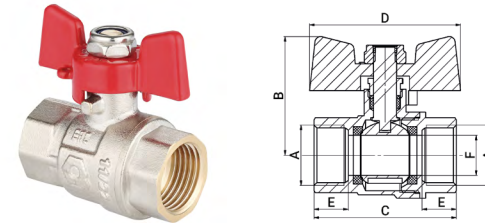

BALL VALVE FEMALE-FEMALE CONNECTION WITH T HANDLE

Closure tightness class – A
 Reparability – Yes
 Nominal diameter – 1/2"
 Nominal operating pressure, PN – 40 bar
 Maximum operating temperature – 100°C
 Minimum operating temperature – -10°C
 Connection type – Threaded
 Threaded connection standard – ISO288/1
 Type of flow section – Full bore
 Body in nickel-plated brass

A	B, mm	C, mm	D, mm	E, mm	F, mm	Weight, g	Product code		
1/2"	41,2	49,8	52,8	12	14	155	ZQBV302D15	17	102
3/4"	46,2	55,0	62	12,3	19	230	ZQBV302D20	13	78
1"	53,9	64,8	72,6	14,5	23	378	ZQBV302D25	9	54

BV

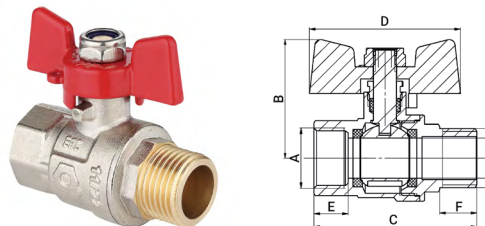

BALL VALVE FEMALE-MALE CONNECTION WITH T HANDLE

Closure tightness class – A
 Reparability – Yes
 Nominal diameter – 1/2"
 Nominal operating pressure, PN – 40 bar
 Maximum operating temperature – 100°C
 Minimum operating temperature – -10°C
 Connection type – Threaded
 Threaded connection standard – ISO288/1
 Type of flow section – Full bore
 Body in nickel-plated brass

A	B, mm	C, mm	D, mm	E, mm	F, mm	G, mm	Weight, g	Product code		
1/2"	41,2	57	52,8	13	12	14	161	ZQBV303D15	17	102
3/4"	46,2	64	62	14	12,3	19	241	ZQBV303D20	12	72
1"	53,9	74	72,6	16	14,5	23	393	ZQBV303D25	9	54

5.2. BALL VALVES WITH TAIL PIECE

BV

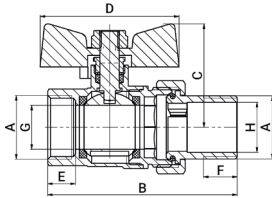

BALL VALVE WITH TAIL PIECE MALE CONNECTIONS

Closure tightness class – A
 Reparability – Yes
 Nominal diameter – 1/2" – 1*1/4"
 Nominal operating pressure, PN – 40 bar
 Maximum operating temperature – 100°C
 Minimum operating temperature – -10°C
 Connection type – Threaded
 Threaded connection standard – ISO288/1
 Type of flow section – Full bore
 Body in nickel-plated brass

A	B, mm	C, mm	D, mm	E, mm	F, mm	G, mm	H, mm	Weight, g	Product code		
1/2"	75,3	41,3	52,8	12	13,5	14	15	215	ZQBV310D15	10	100
3/4"	85,2	46,3	62	12,3	14,7	19	20	329	ZQBV310D20	7	70
1"	99,1	54	73	14,5	17,5	23	26	543	ZQBV310D25	4	40
1 1/4"	110	58,7	73	15,5	18,5	29	34	725	ZQBV310D32	4	24

5.3. BIBCOCK

BV

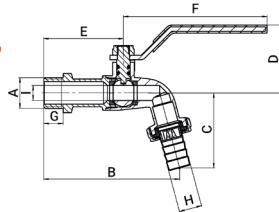

BIBCOCK WITH LEVER HANDLE

Closure tightness class – A
 Reparability – No
 Nominal diameter – 1/2"
 Nominal operating pressure, PN – 16 bar
 Maximum operating temperature – 100°C
 Minimum operating temperature – -10°C
 Connection type – Threaded
 Threaded connection standard – ISO288/1
 Body in nickel-plated brass

A	B, mm	C, mm	D, mm	E, mm	F, mm	G, mm	H, mm	I, mm	Weight, g	Product code		
1/2"	90,9	50	45,4	53,3	96,2	13	15,2	10	235	ZQBV320D15	8	80

5.4. BALL VALVE WITH DRAIN AND AIR VENT

BV

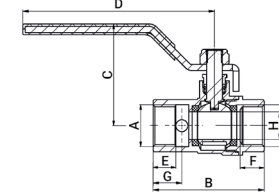

BALL VALVE WITH DRAIN AND AIR VENT

Closure tightness class – A
 Reparability – Yes
 Nominal diameter – 1/2"
 Nominal operating pressure, PN – 40 bar
 Maximum operating temperature – 100°C
 Minimum operating temperature – -10°C
 Connection type – Threaded
 Threaded connection standard – ISO288/1
 Type of flow section – Full bore
 Thread size drain outlet/air vent – 1/4"
 Body in nickel-plated brass

A	B, mm	C, mm	D, mm	E, mm	F, mm	G, mm	H, mm	Weight, g	Product code		
1/2"	55,8	51	96,2	11,5	12	14,5	14	255	ZQBV330D15	8	80

5.5. DRAIN VALVE

BV

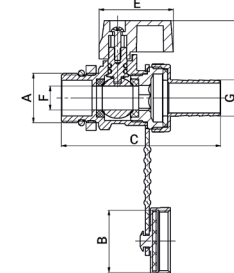

DRAIN VALVE

Closure tightness class – A
 Reparability – No
 Nominal diameter – 1/2"
 Nominal operating pressure, PN – 10 bar
 Maximum operating temperature – 100°C
 Minimum operating temperature – -10°C
 Connection type – Threaded
 Threaded connection standard – ISO288/1
 Body in nickel-plated brass

A	B	C, mm	D, mm	E, mm	F, mm	G, mm	Weight, g	Product code		
1/2"	3/4"	66,7	32,4	31,1	10	15,2	128	ZQBV340D15	20	200

BV

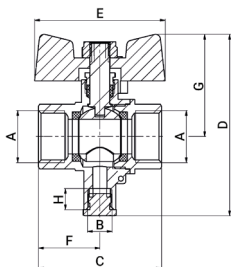

BALL VALVE WITH TEMPERATURE SENSOR SOCKET

Closure tightness class – A
 Reparability – Yes
 Nominal diameter – 1/2"
 Nominal operating pressure, PN – 40 bar
 Maximum operating temperature – 100°C
 Minimum operating temperature – -10°C
 Connection type – Threaded
 Threaded connection standard – ISO288/1
 Type of flow section – Full bore
 Thread size for temperature sensor connection – M10*1
 Thread length for temperature sensor – 8,5 mm

A	B, mm	C, mm	D, mm	E, mm	F, mm	G, mm	H, mm	Weight, g	Product code		
1/2"	M10*1	49,8	73,3	53	24,85	41,3	8,5	196	ZQBV331D15	12	72

5.7. BALL VALVE WITH STRAINER

BV

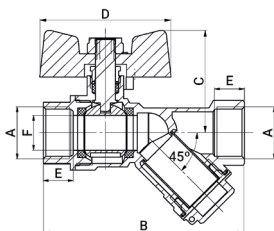

BALL VALVE COMBINED WITH STRAINER

Closure tightness class – A
 Reparability – Yes
 Nominal diameter – 1/2"
 Nominal operating pressure, PN – 40 bar
 Maximum operating temperature – 100°C
 Connection type – Threaded
 Threaded connection standard – ISO288/1
 Type of flow section – Full bore
 Filter element size – 500 microns
 Body in nickel-plated brass

A	B	C, mm	D, mm	E, mm	F, mm	Weight, g	Product code		
1/2"	80,8	41	53	12	14	230	ZQBV341D15	12	120

CRV

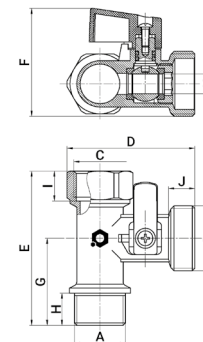

TEE BALL VALVE FEMALE-MALE CONNECTION FOR WASHING MACHINE

Reparability – No
 Nominal operating pressure, PN – 10 bar
 Test pressure – 16 bar
 Maximum operating temperature – 80°C
 Flow rate, Kv – 2,34 m3/h

A	B	C	D, mm	E, mm	F, mm	G, mm	H, mm	I, mm	J, mm	K, mm	Weight, g	Product code		
1/2"	3/4"	1/2"	51,2	62	43,5	35	13	12	10,5	8	116	ZQCRV001	1	100

CRV

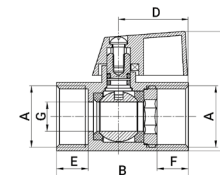

BALL VALVE MINI FEMALE-FEMALE CONNECTION

Reparability – No
 Nominal operating pressure, PN – 10 bar
 Test pressure – 16 bar
 Maximum operating temperature – 80°C
 Flow rate, Kv – 3,72 m3/h

A	B, mm	C, mm	D, mm	E, mm	F, mm	G, mm	Weight, g	Product code		
1/2"	44,5	40,7	23,8	11,5	10,7	10	104	ZQCRV002	1	100

CRV

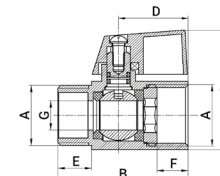

BALL VALVE MINI FEMALE-MALE CONNECTION

Reparability – No
 Nominal operating pressure, PN – 10 bar
 Test pressure – 16 bar
 Maximum operating temperature – 80°C
 Flow rate, Kv – 3,72 m3/h

A	B, mm	C, mm	D, mm	E, mm	F, mm	G, mm	Weight, g	Product code		
1/2"	45	40,7	23,8	10,8	10,7	10	96	ZQCRV003	1	100

CRV

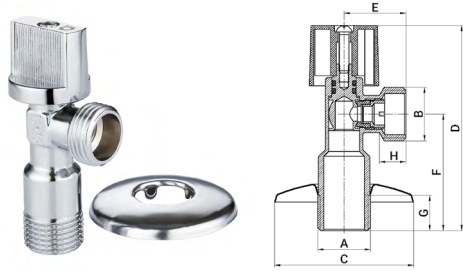

UNDER-SINK ANGLE BALL VALVE

Reparability – No
 Nominal operating pressure, PN – 10 bar
 Test pressure – 16 bar
 Maximum operating temperature – 80°C
 Flow rate, Kv – 1,32 m³/h

A	B	C, mm	D, mm	E, mm	F, mm	G, mm	H, mm	Weight, g	Product code		
1/2"	1/2"	52	80	24	45,5	13	10,5	79	ZQCRV004	2	100
1/2"	3/4"	52	80	24	45,5	13	10,5	84	ZQCRV005	2	100

CRV

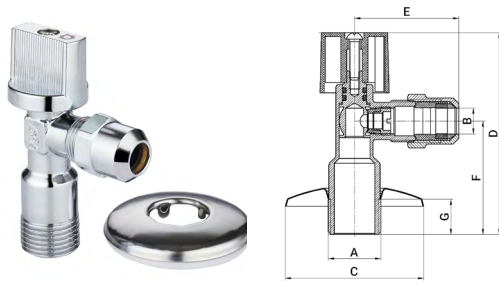

UNDER-SINK ANGLE BALL VALVE WITH NUT AND WASHER

Reparability – No
 Nominal operating pressure, PN – 10 bar
 Test pressure – 16 bar
 Maximum operating temperature – 80°C
 Flow rate, Kv – 1,32 m³/h
 Size – 1/2*3/8*M10

A	B, mm	C, mm	D, mm	E, mm	F, mm	G, mm	Weight, g	Product code		
1/2"	10	52	80	40	45,5	13	92	ZQCRV006	1	100

CRV

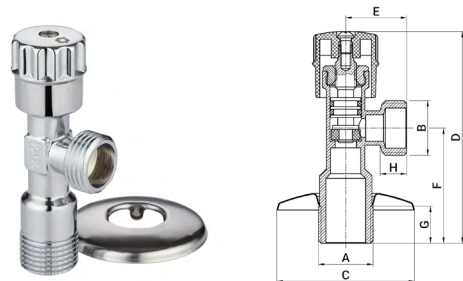

ANGLE VALVE

Reparability – No
 Nominal operating pressure, PN – 10 bar
 Test pressure – 16 bar
 Maximum operating temperature – 80°C
 Flow rate, Kv – 1,92 m³/h

A	B	C, mm	D, mm	E, mm	F, mm	G, mm	H, mm	Weight, g	Product code		
1/2"	1/2"	52	79–85	23	43,5	14	10	88	ZQCRV007	1	100



For sales, pls contact:

ALEXEY KAPLUNOVSKY

E-mail: alexey@zencq.com

Tel. +49 30 16635793 | Mob. +49 176 93101699

www.zencq.com

